

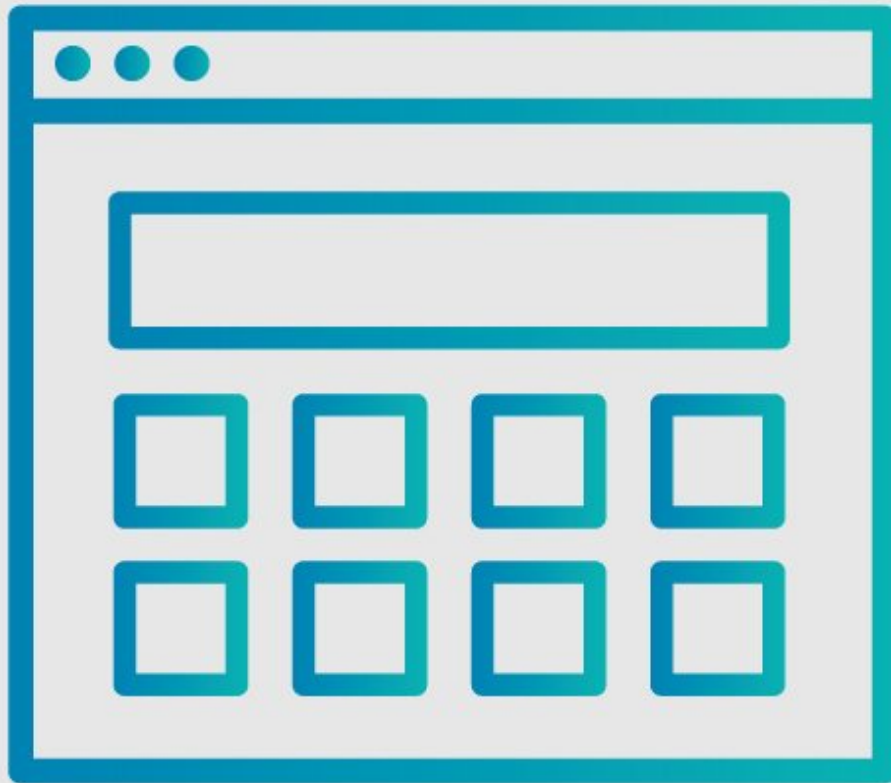

How to Create an Item Page

This guide demonstrates how to create an item page.

Written By: Dozuki System



INTRODUCTION

This guide demonstrates how to create an item page.

Step 1 — Create a Page

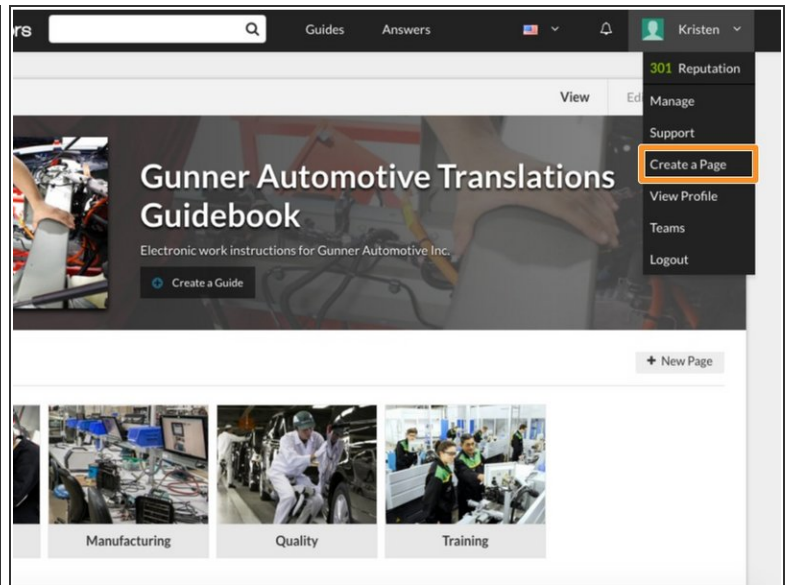
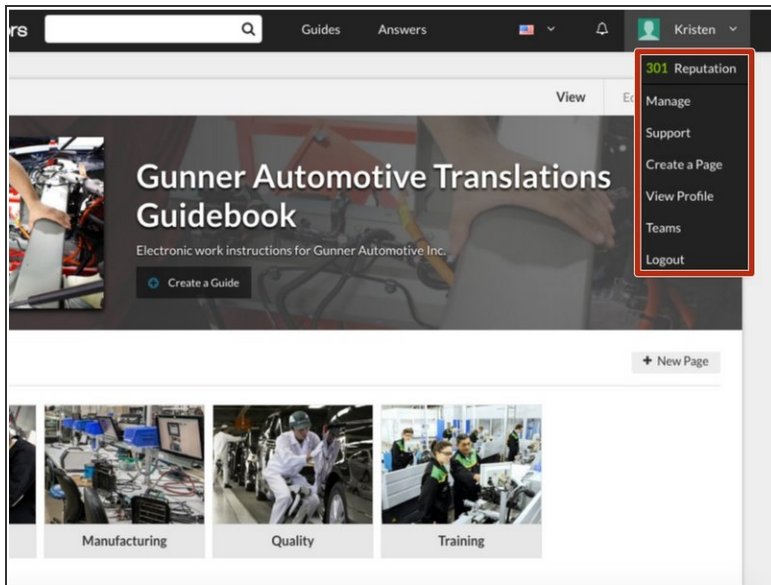

- Click on the drop-down menu where your name appears in the upper right hand corner of the screen.
- Click on **Create a Page**.

Step 2 — Create a Title

The image shows two screenshots from a web application. The left screenshot, titled "Start a New Page", displays four options: Guide, Category, Wiki, and Item. The "Item" option is highlighted with a red border. The right screenshot shows the "Item" creation form with a title input field containing the word "Hammer" and a "Next" button highlighted with a yellow border.

Start a New Page
New pages are just the beginning. It's easy for others to pitch in and help make it awesome.

Guide
Step by step how-to instructions. Using high quality photographs and clear explanations, teach someone how to do something!

Category
Create a manual about a specific category. Make other people awesome by teaching them what you know.

Wiki
Documents with flexible formatting for general info, like troubleshooting pages. Be sure to add a link to it so people can find it!

Item
Tools, materials, or parts required for projects or repairs. Once added, these items can then be listed in how-to guides.

you know.

Item
Tools, materials, or parts required for projects or repairs. Once added, these items can then be listed in how-to guides.

Title

Hammer

Next

ment can be translated into other languages.

- Start a new page. Select **Item**.
- Give your new Item Page a title.
- Click **Next**.

Step 3 — Add Details

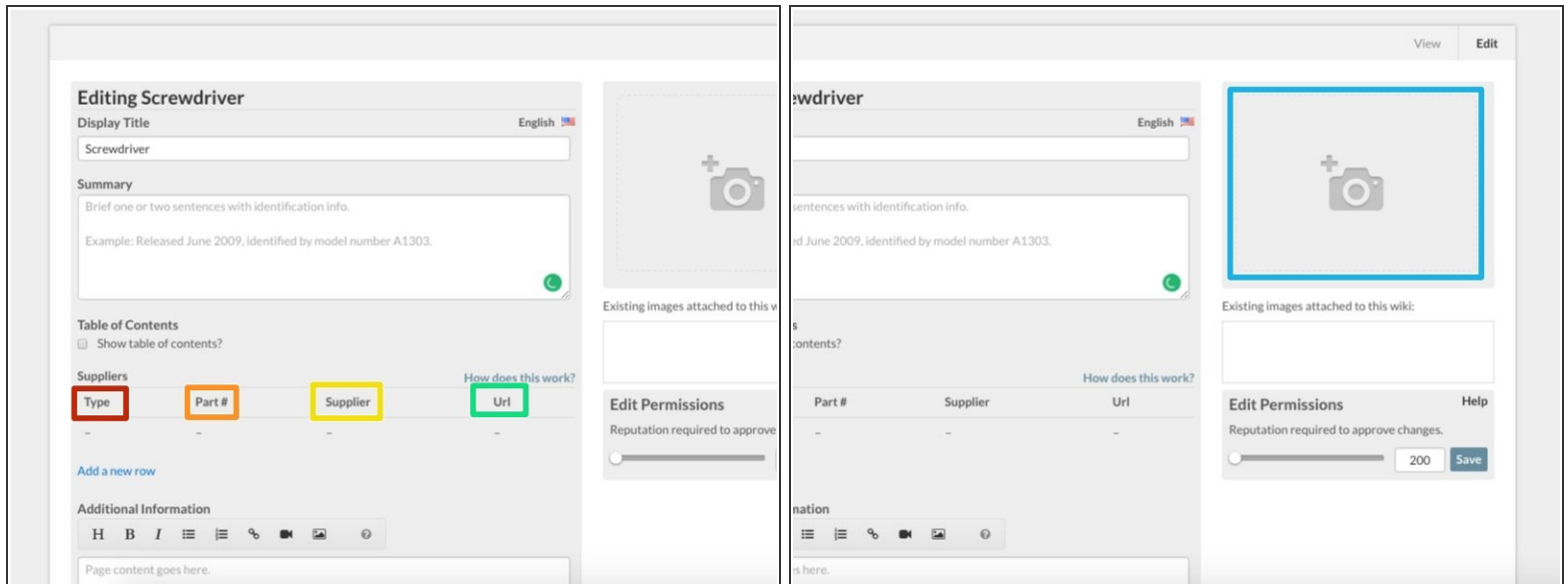

- You can now customize the page for the item.
 - Enter the Item type. For example, is the item a Part or Tool?
 - Enter in the **Part Number**.
 - Enter in the **Supplier Information**
 - Enter the **URL** where the item can be purchased.
 - To make it easier for your users to identify the item you should add an image of the item.

To reassemble your device, follow these instructions in reverse order.