



Uncertify EFRs

Follow these quick steps to easily uncertify an EFR.

Written By: Support

The screenshot displays the Farmobile application interface. On the left is a navigation menu with options like Dashboard, Machines, Fields, Notes, File Transfer, Reports, Downloads, Inputs, Account, Farmobile Shop, and How-To Guides. The main area shows 'Test Field A' with a grower profile and 191.11 ac. Below this are two activity logs:

- Spray** (Certified): 6/27/2019 - 1:06 PM, EFR ID: abc123d01, Total Applied: 89 gal, Avg Rate: 7 gal/ac, Avg Pressure: 67 psi, Droplet Size: 4, Product: Water, Worked Acres: 185.68 ac, Date: May 16, Source: 1 PUC.
- Plant** (Certified): 8/16/2019 - 10:51 AM, EFR ID: abc123d02, Crop: Corn, Seed Variety: DKC26-40RIB, Avg Population: 41,868.22 seeds/ac, Worked Acres: 187.85 ac, Date: May 16, Source: 1 PUC.

Each log has buttons for 'View Original', 'Metrics', and 'Uncertify'. A map on the right shows the field layout. An 'UNCERTIFY EFR' dialog box is open on the right side, asking 'Are you sure you want to uncertify efr abc123d02 ?' with 'Uncertify' and 'Cancel' buttons.

Step 1 — Navigate to Fields

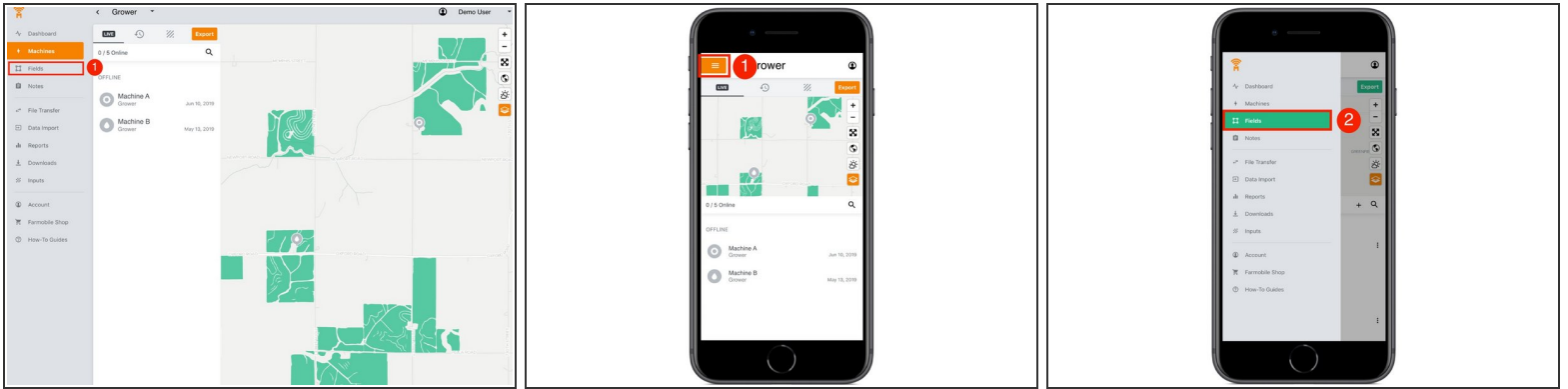

- Select 'Fields' in the Farmobile DataEngineSM platform menu to navigate to your fields.

Step 2 — Select a Field

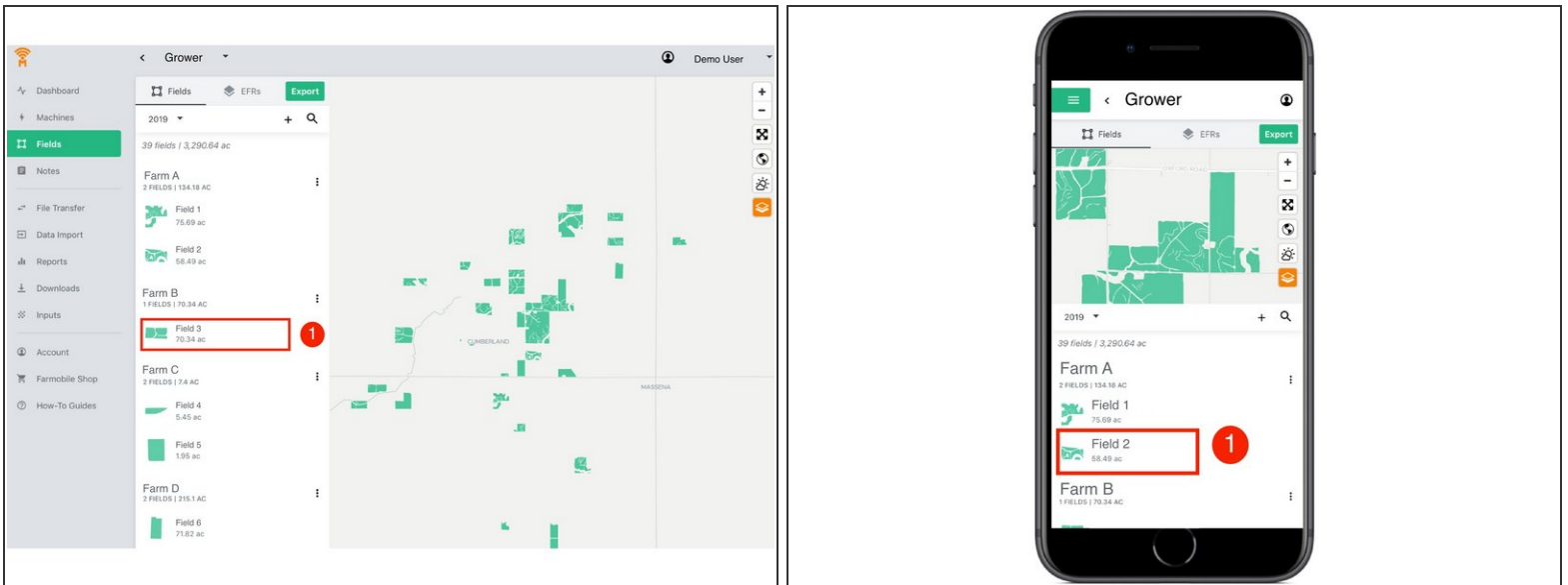

- 1. Select a field to view which EFRs need to be uncertified.

Step 3 — Select Uncertify

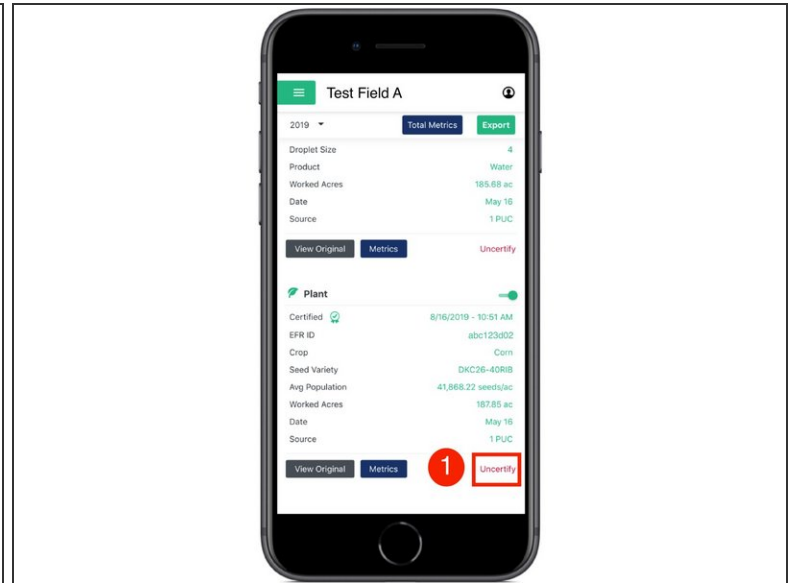
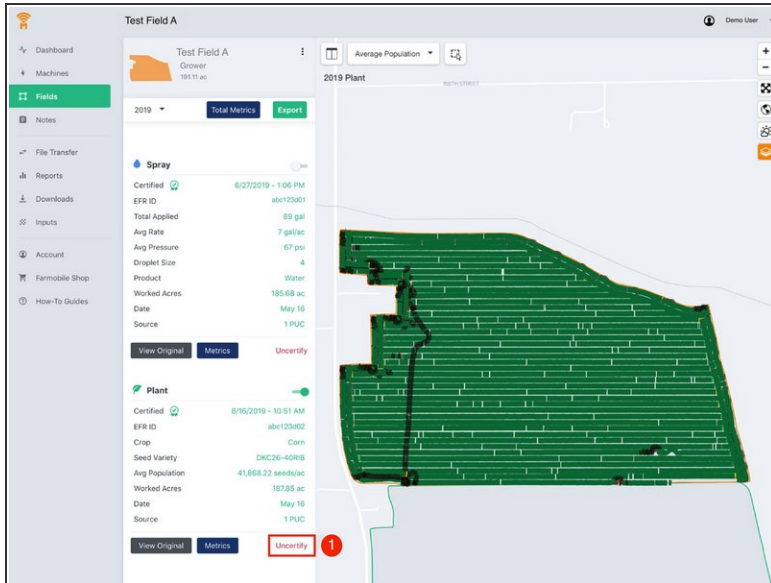

- Select 'Uncertify' to update the EFR and certify it with the correct information.
- ❗ The certified values will be removed once an EFR is uncertified.
- ❗ The ability to uncertify an EFR is also available within EFR Views.

Step 4 — Confirm to Uncertify

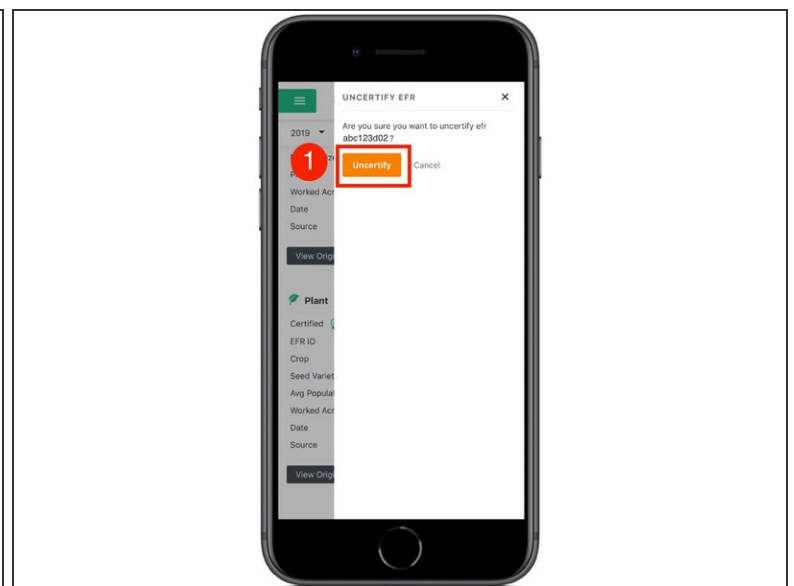
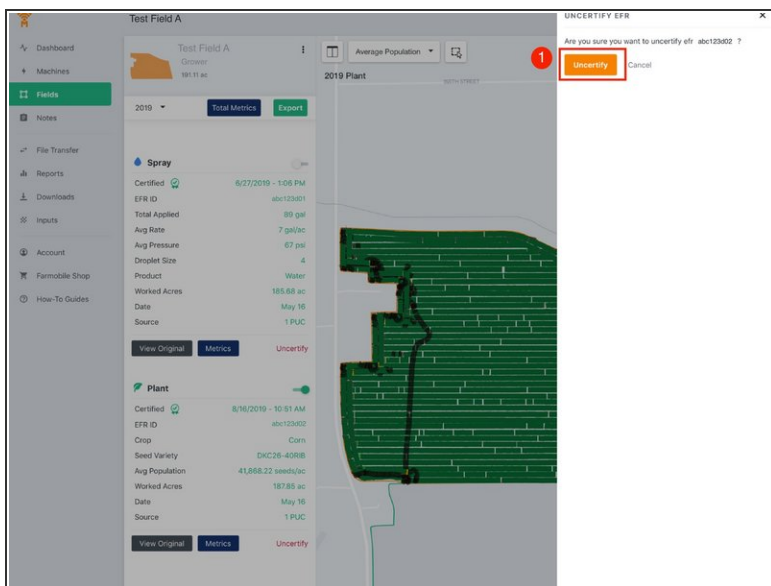

- Confirm you want to uncertify the EFR by selecting the 'Uncertify' button.

Step 5 — Review and Update your EFR

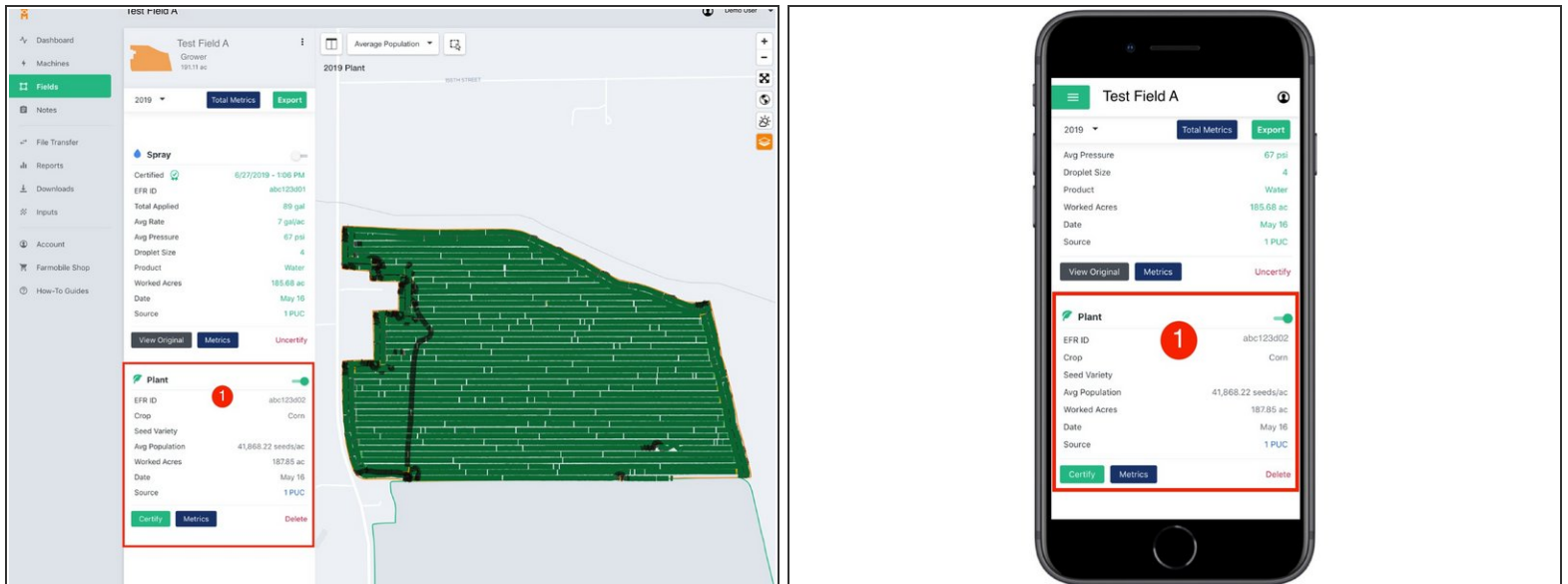

- The certified data is removed from the EFR.
- ❗ Once uncertified, the EFR edit tools become active again.
- ❗ Select 'Certify' to certify the EFR and enter the correct information.