



# Upload File or Folder

Upload a File or Folder from Farmobile DataEngine to your PUC.

Written By: Support

**File Transfer Demo PUC**  
Farmobile Support  
Firmware 4.170000  
MAC 0023A7CEDC68

Last seen **35s ago**  
14 files  
10 folders  
1 pending item

**FILE TRANSFER** [Upload] [New Folder]

Home

Select All

- Rx**
- viper**
- Farmobile Harvest Data Out.imt** 3 kb Oct 13, 2017 4:13 pm

## INTRODUCTION

- Ability to Upload files or folders to PUCs
- Upload works for both Online and Offline PUCs
  - Files sync in real time with all Online PUCs.
  - Files sync in real time with Offline PUCs once they become Active. While Offline, any files or folders uploaded will be staged and set to pending status until the PUC comes Online.

## Step 1 — Select File Transfer from the Farmobile® DataEngine™ Menu

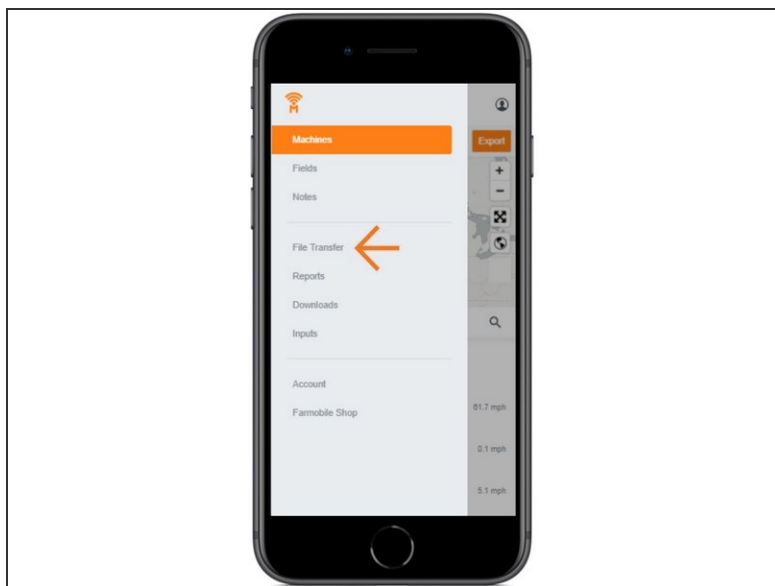
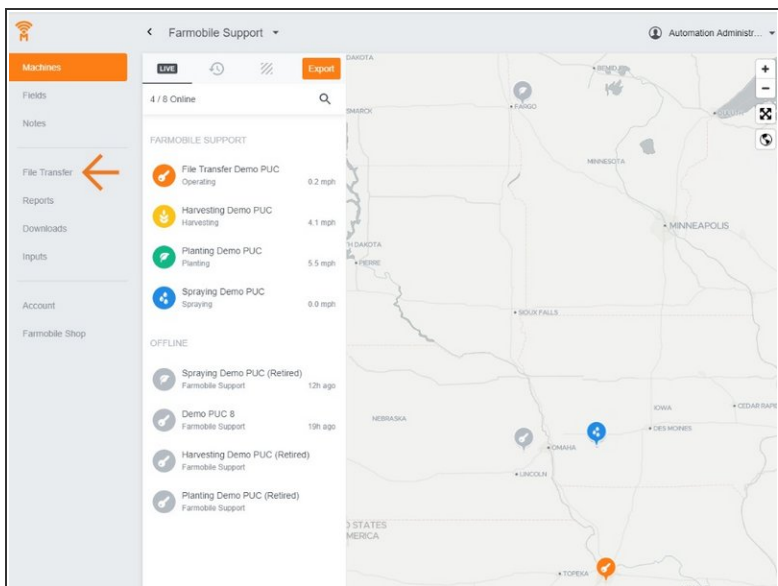

- Selecting 'File Transfer' from the Farmobile® DataEngine™ menu will open the File Transfer page with all of your PUCs listed.

## Step 2 — Select a PUC

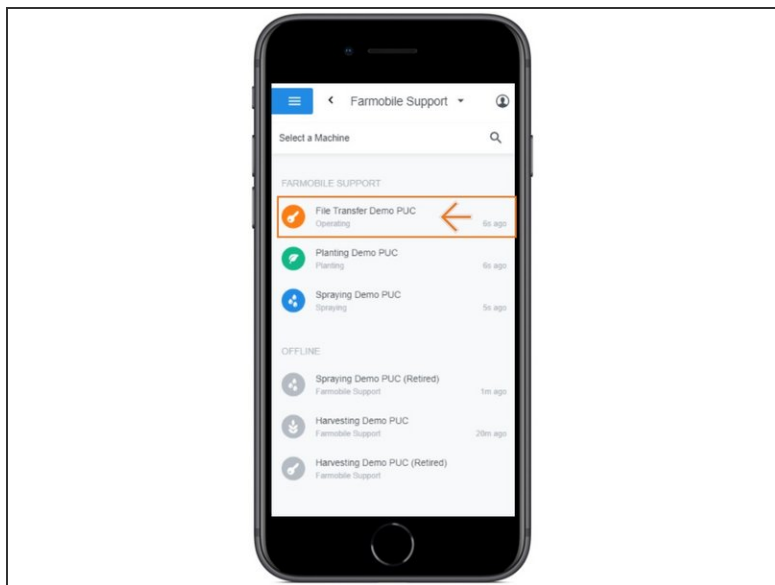
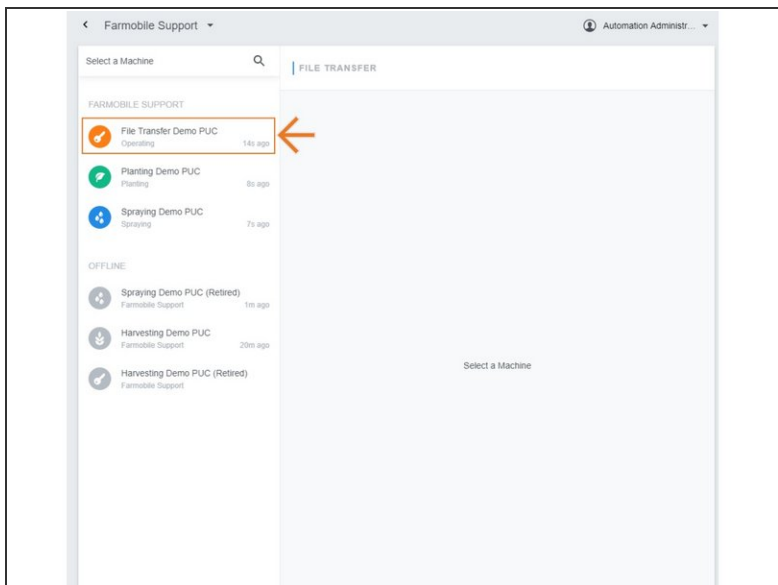

- From the list of PUCs, select the required PUC to upload a file or folder to.

## Step 3 — Select Upload

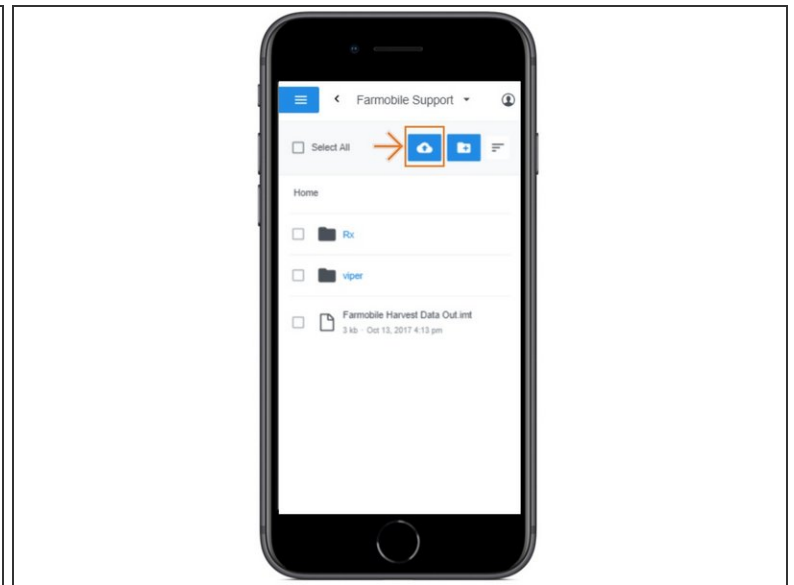
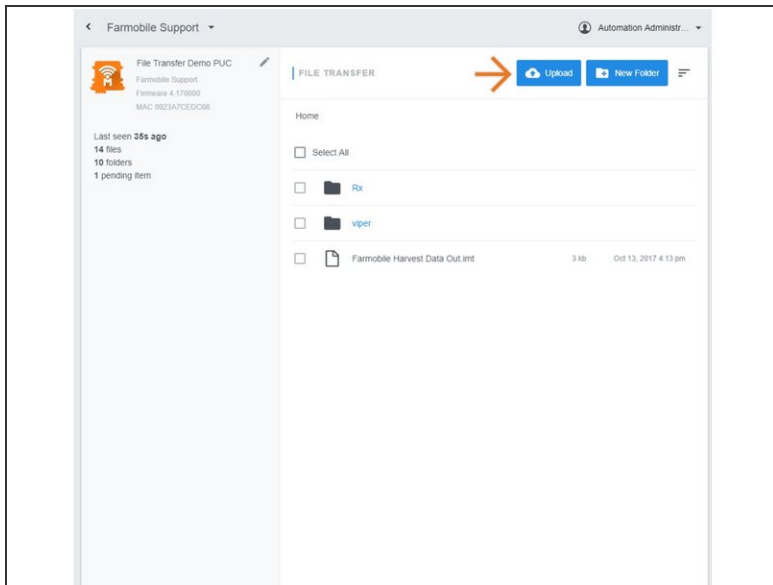

- Select 'Upload' to open the upload window.

## Step 4 — Upload File or Folder

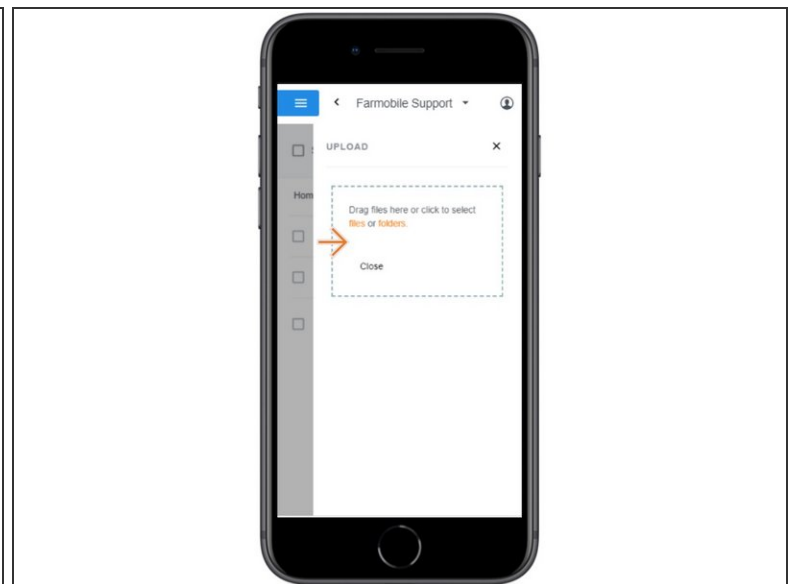
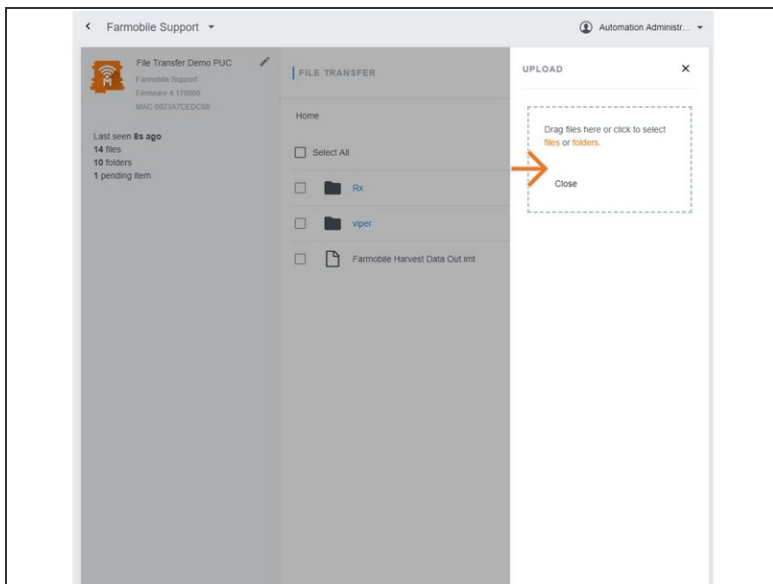

- Within the upload window, you can drag and drop files and folders or navigate to the file or folder location to upload.
- The File or Folder will be added to the list associated to the PUC.
- A status label is included tracking the file or folder progress.

This document was last generated on 2019-07-23 05:55:01 PM.