

Makertech

DSE Only - Stage 07: Spool Holder

Written By: Makertech



Step 1 — Installing the Second Spool Holder



- i** Installing the included spool holder is optional, the steps here will show you how to install it to an aluminium extrusion.

Step 2 — Preparing the Spool Holder

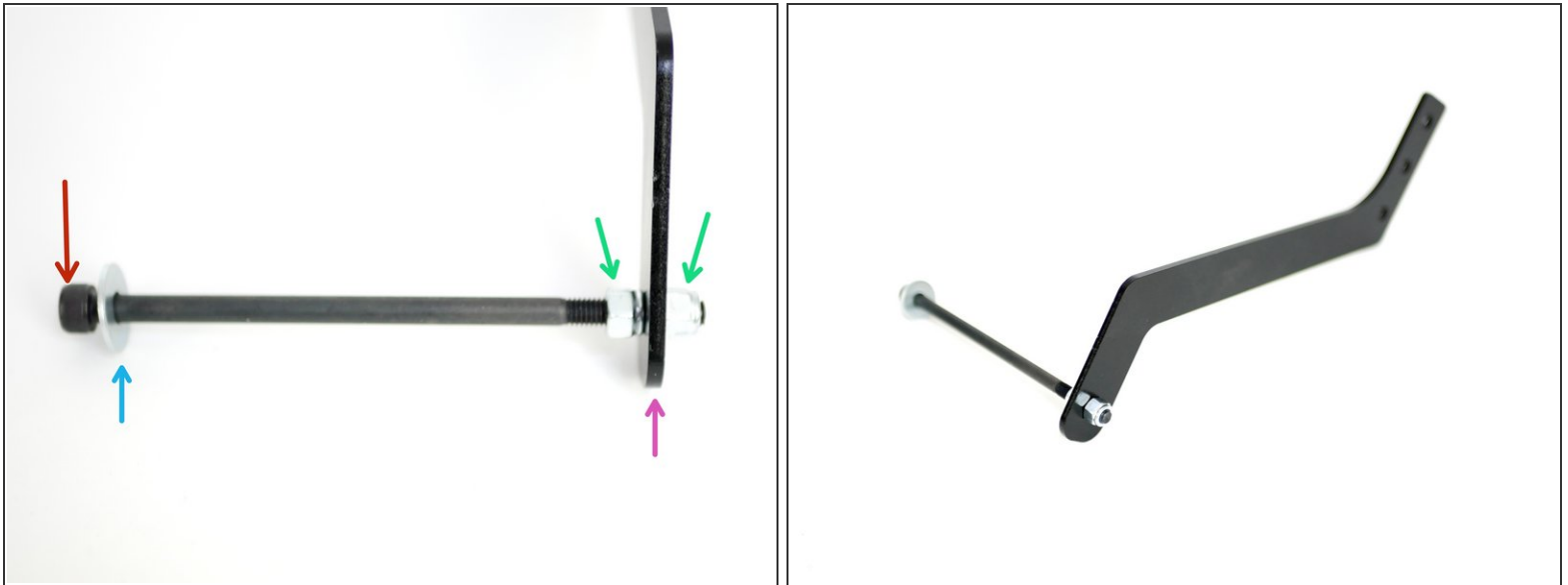

i Prepare the second spool holder like shown in the images, with the M5x100mm bolt on the left side.

- Spool Holder
- M5 x 100mm bolt
- M5 15mm washer
- M5 Nyloc Nut

Step 3 — Mounting the Spool Holder



- Fasten on to the second spool holder three M5 T-nuts and M5 x 8mm bolts.
- Fix the second spool holder onto the frame.