



# Roller Guides

Written By: Dozuki System

## INTRODUCTION

[Sketchup Model](#)Note: Model doesn't show the proper bolts for the bearings. Additional Materials Required:\* V-Groove Bearings (2)\* 1/2"x 2.5" Bolts (2)\* M12x55mm Bolts (4)\* M12 Nuts (4)\* Washer, Lock 12mm (8)

---

### TOOLS:

- [Angle grinder](#) (1)
  - [hole puncher](#) (1)
  - [Welder](#) (1)
  - [Wrench](#) (1)
-

## Step 1 — Grind the bolts



- Grind off the top of the 12mm bolts so that the head is 1/4" thick or less.
- This is so that the bolts will not be touching the drawer as it slides in and out.

## Step 2

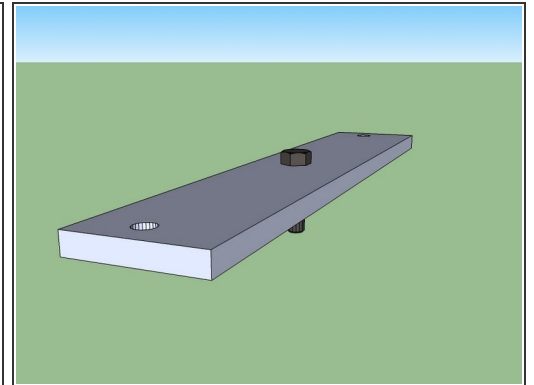
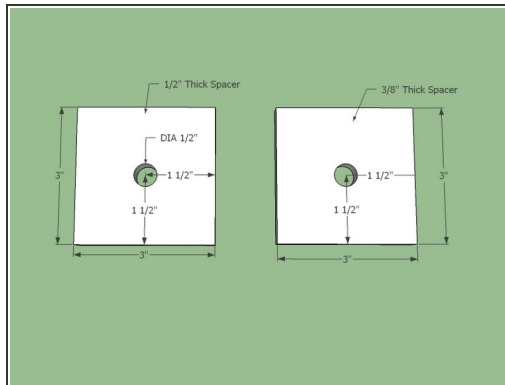
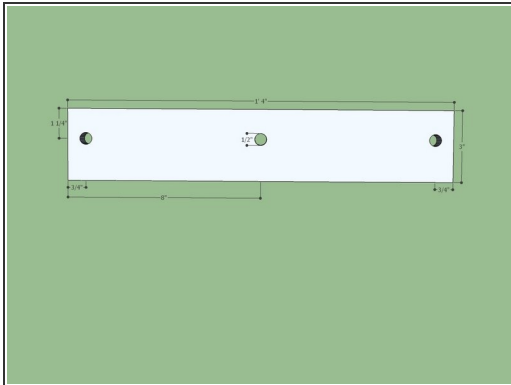

- Punch the holes in the main plates and the spacer plates.
- Weld the 1/2" bolts in the center hole, from the bolt head side.

### Step 3 — Assemble

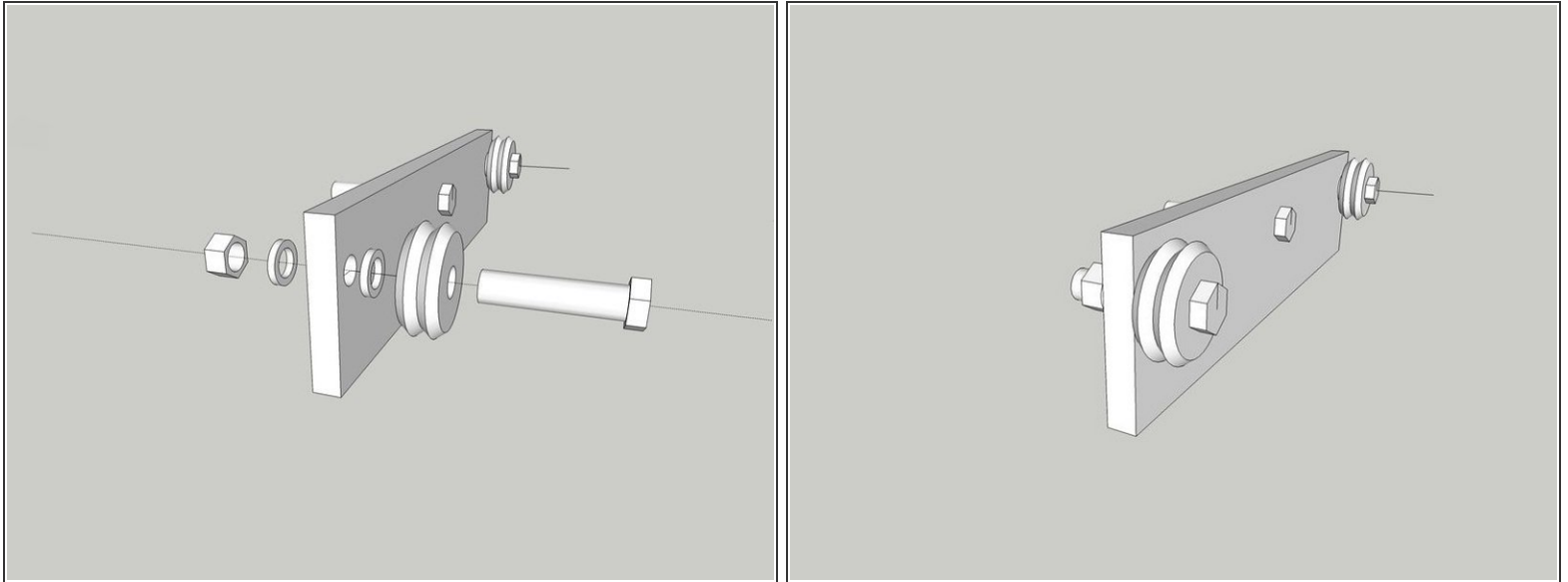

- Assemble the bearings to the plate as shown, with lock washers on each side of the main plate.